

L200

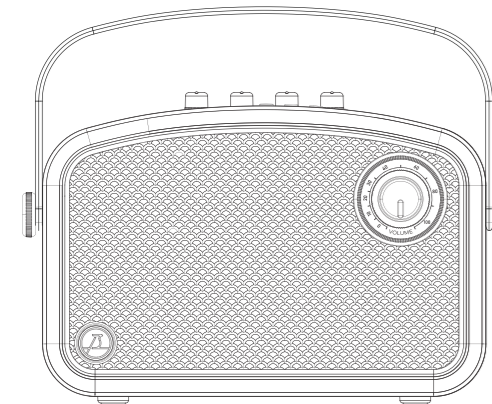

**SAINTLARK**  
LISTEN TO THE WORLD



Operation Manual

WWW.SAINTLARK.COM

**Products**

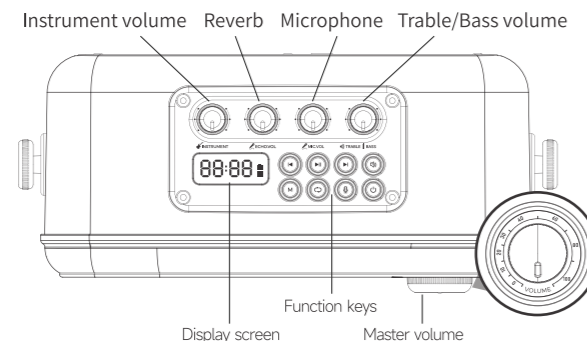

**Knob Function Description**

**Instrument volume:** Rotate the Instrument volume clockwise to increase, rotate the reverb volume counterclockwise to decrease  
**Reverb volume:** Rotate the reverb volume clockwise to increase, rotate the reverb volume counterclockwise to decrease  
**Microphone volume:** Rotate the Microphone volume clockwise to increase, rotate the reverb volume counterclockwise to decrease  
**Headset monitor volume:** Rotate the Headset monitor volume clockwise to increase, Rotate clockwise from 0 to -6 to decrease treble volume, and rotate counterclockwise from 0 to -6 to decrease bass volume.

**Description of key functions**

- Power on/off:** In the off state, press and hold for 3 seconds to turn on the device. In the on state, press and hold for 3 seconds to turn off the device.
- Recording:** Long press the record button to enter recording mode, short press to end recording, play the recording file, and short press again to return to the current mode.
- Loop playback:** Short press to switch between single song/all songs loop.
- Mode switching:** Short press to switch between USB flash drive/TF card/Bluetooth/UH-F/AUX modes when inserting USB flash drive/TF card/AUX mode. Long press to disconnect Bluetooth connection in Bluetooth mode
- One-touch mute:** Short press the mute button to mute the machine. You can listen to the machine's sound through the monitoring headphones. Short press the mute button again to unmute.
- Next track:** Short press to play the next track, long press to fast forward
- Pause/Play:** Short press to pause, short press again to play.
- Previous track:** Short press to play the previous track, long press to fast forward

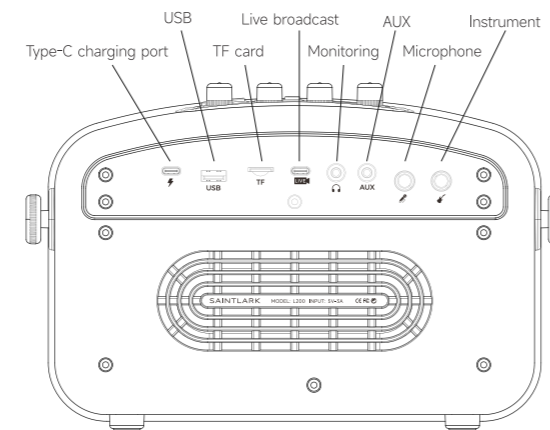

**Socket Function Description**

**TYPE-C charging port:** When charging, connect the TYPE-C charger to the TYPE-C socket of the main unit, and then connect to the power supply (100-240V) socket to charge  
 NOTE:  
 a. When the machine prompts the battery to be low during the working time, please charge the battery in time; the machine Charging time takes 4-6 hours;  
 b. When you use the main unit for the first time, the battery has a small portion of power, but in order to achieve the best results, it is recommended to be fully charged before use;  
 c. This machine is suitable for all types of cell phone chargers to charge the machine, charging is complete, you can conveniently disconnect the power supply by unplugging the power adapter.

**U disk interface:** Insert the U disk with audio to play  
**TF card interface:** Insert the TF card with audio to play  
**Live streaming interface:** The device connects to a mobile phone via a live streaming cable, enabling OTG live streaming (Note: The live streaming cable is not included with the device upon purchase).  
**Monitoring headphone jack:** Inserted into the 3.5mm headphones can monitor local music playback and microphone sound  
**Audio Input:** Inserted into the 3.5mm universal audio input connector, can be connected to external audio devices  
**Microphone jack:** Plug in a 6.35mm wired microphone  
**Instrument jack:** Plug in a 6.35mm jack electric flute or guitar, etc.

**Introduction to Microphone**

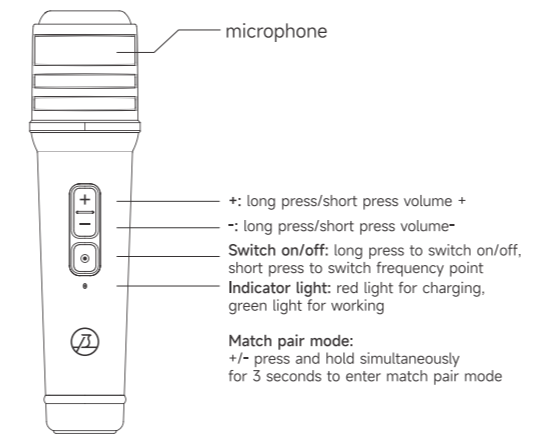

**Specification**

<b>Output Power</b>	≤60W	<b>Frequency Response</b>	60HZ-18KHZ
<b>Battery Capacity</b>	11.1V/4000mAh	<b>signal-to-noise ratio</b>	≥70dB
<b>Charging Voltage</b>	5V-3A	<b>Bluetooth</b>	≈10 meters
<b>Charging Time</b>	4 ~ 6 hours	<b>Playing time</b>	3 ~ 4 hours

**Wireless Bluetooth pairing schematic:**

**Step 1:** Turn on the device, press the M key to switch to Bluetooth mode. When the host prompts "Bluetooth mode," it indicates that the device is currently in Bluetooth mode.

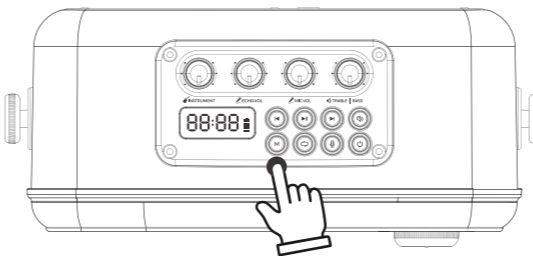

**Step 2:** Turn on your cell phone, enter the "Settings" menu of your cell phone, and find the Bluetooth option. Turn on your phone's Bluetooth function, tap the "Scan" button, and then click "Local Label Model" to connect to it when it searches for "Local Label Model". At the same time, the host will prompt the Bluetooth pairing.

**Step 3:** After successfully connecting, you can play mobile teaching materials, training materials, songs and other audio output through the host.

**UHF wireless microphone pairing schematic:**

**Manual pairing method: for microphone connected wirelessly and need to be re-paired**

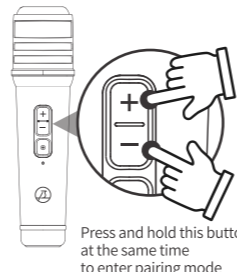

1, open the speaker power switch, short press the M button to switch to wireless mode, and then long press the M button for 3 seconds, the voice prompts UHF waiting for pairing  
 2, open the wireless microphone power switch, at the same time, long press the +/- button, 3 seconds into the UHF wireless pairing mode, when the speaker appears "wireless pairing" prompt, this time the wireless microphone has been Pairing success.

**Caveat**

- In order to achieve the best effect of microphone amplification, please place the microphone head in front of the front of the mouth 1-2cm in front of the microphone head to pronounce, if there is whistling, you can properly reduce the volume or the distance between the machine and the microphone head is slightly pulled apart, in order to prevent each other from interfering.
- In order to ensure the service life of lithium battery, it is recommended to charge after use, frequent charging will accelerate the aging of the battery chip, and it should be charged every two months when not used for a long time.
- Because of the strong magnetism of the speaker, do not put the machine and bank cards and other magnetic things together, so as not to cause loss of magnetism and bring unnecessary trouble.
- All the accessories of this product are designed according to the working needs of this machine, if you need to replace the accessories try to use the company's original accessories, in order to achieve the best working condition.
- This product may become slightly warm during charging and normal use, which is normal.
- Please use an anti-static soft cloth to clean and wipe the product. When cleaning the product, please turn off the power switch and disconnect all external connections. Do not wipe with chemicals (e.g., chemical detergents such as alcohol, benzene, or abrasive cleaning wipes).
- Please do not drop, throw or step on the product, and do not disassemble the product without authorization, or you will not be entitled to our free warranty service.

**Self-solutions of common problems.**

1. switch on, no sound  
 A. screen lights do not light, power supply is dead, charging solution.  
 B. Volume adjustment is at the minimum position, adjust the volume appropriately
  2. There is obvious whistling  
 A. Aim the microphone microphone at the direction of the corner of the mouth, the microphone and the host to maintain a distance of 2-3m  
 B. The space becomes small, you should lower the volume appropriately so as not to cause whistling.
- If you still have the above problems, please contact after-sales customer service

**FCC Warning:**

This device complies with Part 15 of the FCC regulations. Operation is subject to the following two conditions:  
 (1) This device may not cause harmful interference  
 (2) This device must accept any interference received, including interference that may cause undesired operation.

Any changes or modifications not expressly approved by the party responsible for compliance may cause the user to lose authority to operate the equipment.

Notes:This equipment has been tested and found to comply with the limits for a Class B digital device, pursuant to Part 15 of the FCC regulations. These limits are established to provide reasonable protection against harmful interference in a residential installation. This equipment may generate use and radiate radio frequency energy that, if not installed and used in accordance with the instructions, may cause harmful interference to radio communications. However, there is no guarantee that interference will not occur in a particular installation. If the equipment does cause harmful interference to radio or television reception, which can be determined by turning the equipment off and on, the user may attempt to correct the interference by one or more of the following measures.

- Reorient or relocate the receiver antenna.
- Increase the spacing between the equipment and the receiver.
- Connect the equipment to an outlet on a circuit different from the circuit to which the receiver is connected.
- Consult your dealer or consult a technician specializing in radios/TVs for assistance.

The device has been evaluated and meets the requirements for general RF exposure. The device can be used under portable exposure conditions without restriction.

**Safety warning**

- Keep products and accessories away from fire or any excessive heat.
- Do not expose the product and accessories to water and moisture, do not use the unit near water, and do not immerse the product in any liquid to avoid dripping or splashing the product and accessories.
- Do not open or arbitrarily disassemble or repair the battery components by yourself, there is a danger of explosion if the battery is not replaced properly, and it is strictly prohibited to put the battery into water, fire, or near any overheated environment.
- This product is charged by an external power adapter (5V-2A) and then used. After charging, you can conveniently disconnect the grid power by unplugging the power adapter.
- When the user does not use the product for a while, please turn the product power switch to the off state to turn off the power (see the product control diagram), to avoid the loss of battery power.
- Turn off this product when the use of wireless devices is prohibited or when the use of devices causes interference with electronic equipment and safety hazards.
- Turn off the product in flammable and explosive areas and follow the instructions on the label to avoid explosion or fire. Flammable and explosive areas include, but are not limited to: gas stations, transportation and storage facilities for flammable or chemical products, areas marked with an explosion hazard symbol, areas marked with a "turn off two-way radio" symbol.
- When traveling by air, please comply with the relevant rules and regulations of the airlines and turn off the product before takeoff to avoid safety hazards.
- Safe for use in non-tropical climates only, and safe for use at altitudes of up to 2000 meters above sea level only.