

Function Illustration

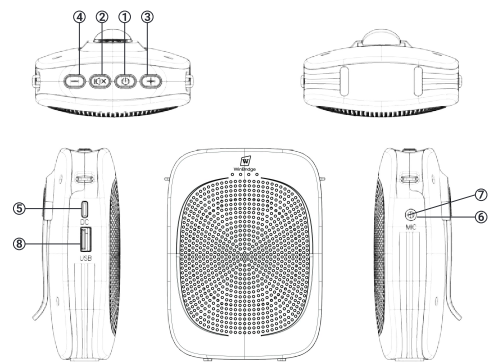

1. Long press to power on or power off | Double click to turn on or off Bluetooth | In music model, press briefly to pause or play music
2. Only control muting the music
3. Short press to increase the music volume
4. Short press to decrease the music volume
5. DC charging jack
6. Mic jack
7. Reset button
8. USB port

1

Please note that the mute button and the +/- buttons on the speaker can only control the volume of the music played by the device. If you want to adjust the sound volume, please use the corresponding buttons on the U10 transmitter.

U10 Transmitter/Lapel Mic

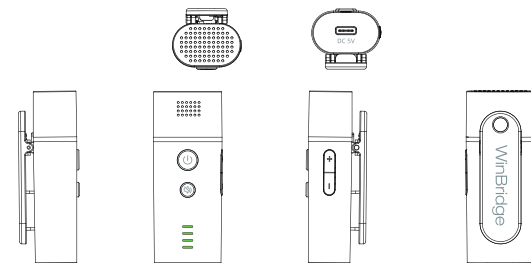

- ⏻ Long press to power on or power off
- ⏻ Short press to mute or unmute
- ⏻ Short press to increase mic volume
- ⏻ Short press to decrease mic volume
- ⏻ Charging jack

Please note that the volume has only three levels: low, medium, and high. The default volume level upon startup is medium. There is no audio notification when adjusting to the lowest or highest volume levels with a short press.

2

How to amplify voice

Operation is straight forward, just turn speaker and lapel mic on, they will be paired automatically, then you could amplify voice.

How to Connect Bluetooth

Long press to power on, then double-click to turn on Bluetooth, the speaker emits a “beep” prompt. Open your Bluetooth device, such as a phone, and search for Bluetooth named C006. Click to pair, and when the pairing is successfully, the speaker will emit another “beep” prompt. Long press to switch to the next track, long press to switch to the previous track.

How to Play USB Disk

Please insert a USB disk, then the speaker will play music automatically. Ensure your USB disk contains music files.

Short press the button to increase the volume.
Short press the button to decrease the volume.

Long press the button to switch to the next track.
Long press the button to switch to the previous track

3

How to wear voice amplifier unit

Take out the voice amplifier unit, fasten the waist belt to metal hooks on both sides, then tie it on the waist. You can also use the back splint to clinch the voice amplifier on the waistband or trousers.

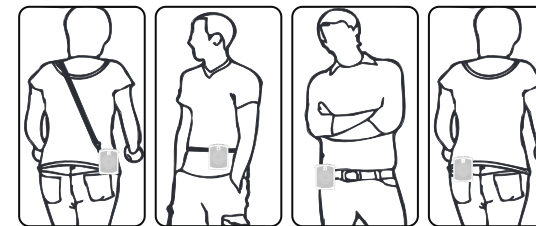

Note: To achieve better audio output, it is not recommended to hang the speaker on the chest. Instead, consider using a belt to attach it to the back of the waist.

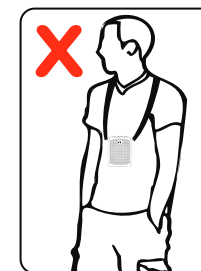

4

How to Wear Wireless Lapel Mic

1. Clip onto Collar.
2. Held in hand.

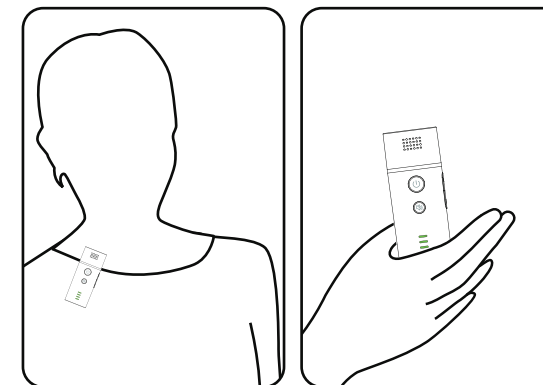

How to reset

If the device freezes (no response when pressing buttons after turning it on), please use something like a toothpick to press the reset button to restore it.

5

How to charge voice amplifier/lapel microphone

Please plug the type c head of charging cable into DC jack on voice amplifier/lapel mic and connect another USB head into 5V charger to charge units. Please be noted that an adapter is not included.

Speaker Charging Status:

The battery indicator lights flash while charging, and the indicator lights keep constantly light when fully charged.

Microphone Charging Status:

When charging, the battery indicator light flashes. Once fully charged, the indicator light stops flashing.

Technical Parameters:

Output power:	15W	Charging current:	110-240 AC
Battery capacity:	2600mAh	Working time:	12-15 hours
Mic working time:	15+ hours	Charging time:	5 hours
Mic Battery:	400mAh	Mic charging time:	2 hours

6



After-sale service

WinBridge provide one year warranty and lifetime technical support.

Toll Free Hotline: +1 (833) 996-2881

info@wwinbridge.com

http:www.winbridgestore.com

Please be confident that seller support is just a mail away from you in case you find any difficulty, kindly do not hesitate to write back to us if you need any clarification or any kind of support.



equipment off and on, the user is encouraged to try to correct the interference by one or more of the following measures:

- Reorient or relocate the receiving antenna.
- Increase the separation between the equipment and receiver.
- Connect the equipment to an outlet on a circuit different from that to which the receiver is connected.
- Consult the dealer or an experienced radio/TV technician for help.

The device has been evaluated to meet general RF exposure requirements. The device can be used in portable exposure conditions without restriction.

FCC Warning:

Any Changes or modifications not expressly approved by the party responsible for compliance could void the user's authority to operate the equipment.

This device complies with part 15 of the FCC Rules. Operation is subject to the following two conditions:

- (1) This device may not cause harmful interference.
- (2) This device must accept any interference received, including interference that may cause undesired operation.

Note:

This equipment has been tested and found to comply with the limits for a Class B digital device, pursuant to part 15 of the FCC Rules. These limits are designed to provide reasonable protection against harmful interference in a residential installation. This equipment generates use and can radiate radio frequency energy and, if not installed and used in accordance with the instructions, may cause harmful interference to radio communications.

However, there is no guarantee that interference will not occur in a particular installation. If this equipment does cause harmful interference to radio or television reception, which can be determined by turning the

Please Noted:

1. Please use a DC 5V plug to charge voice amplifier and microphone.
2. Plug adapter into 110-240 AC outlet, connect the charging cable end into DC 5V power input on speaker/ Mic.
3. In order to extend the life of the internal battery, please charge unit regularly even if system is not being used.
4. Please DO NOT over charge the battery by leaving the system plugged in continuously. This will reduce the life of the internal rechargeable battery and cause over heating.

Package Includes:

- 1*Voice amplifier unit
- 1*Lapel Microphone
- 1*Charging cable
- 1*Waistband
- 1*Manual

Frequently Asked Questions:

Q: Why does the microphone output sound with occasional delay?

A: The amplifier and clip on mic should not be too close to each other, as this can cause delays. As long as you wear the device correctly according to the user manual, the output sound will be very clear and loud.

Q: How to adjust the volume?

A: There are three volume levels: low, medium, and high. The default volume when the device is turned on is set to medium. There is no voice prompt when adjusting the volume.

Q: Why does the sound cut in and out?

A: If the microphone is placed too close to the amplifier unit, it may cause voice distortion or feedback. To avoid this, please ensure the microphone is at least 1 meters away from the amplifier and avoid using the device in environments with strong signal interference.



WinBridge

Voice Amplifier User Manual

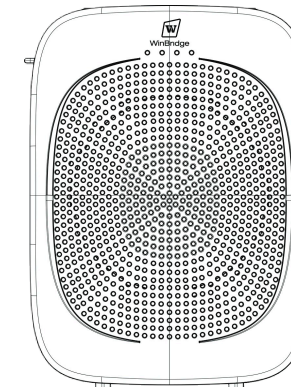

C006