

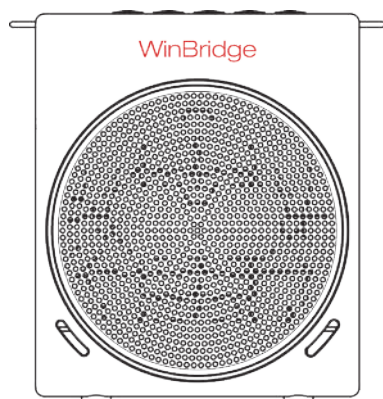

WinBridge

Voice Amplifier User Manual



S91

S91 Function Illustration

- Switch Key:** Press and hold to power on/off
- Mode:** Short press to switch modes among UHF, Bluetooth, AUX
- Short press to increase volume
Long press to skip to next track
- Pause/Resume
- Short press to decrease volume
Long press to select previous track
- 3.5mm Mic Jack
- TF Jack
- Aux Jack
- Charging Jack
- USB Jack

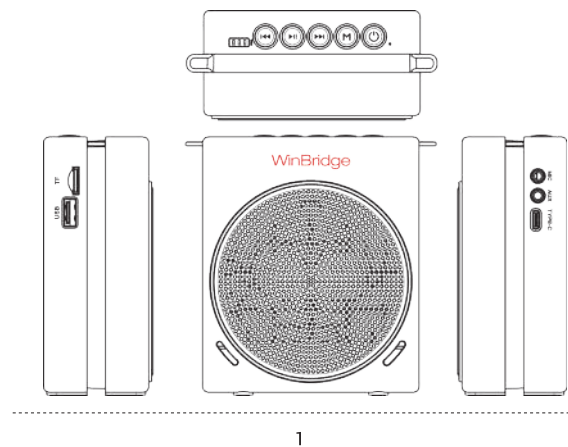

Handheld Microphone

- Hold to turn on/off
- Short press to increase volume
- Short press to decrease volume
- The red light blinks while charging, and it turns off when fully charged
- Type-C charging jack

Headset Microphone

(The wireless microphone is detachable)
Two ways of use: As a normal headset microphone, or remove the bracket to become a handheld microphone.

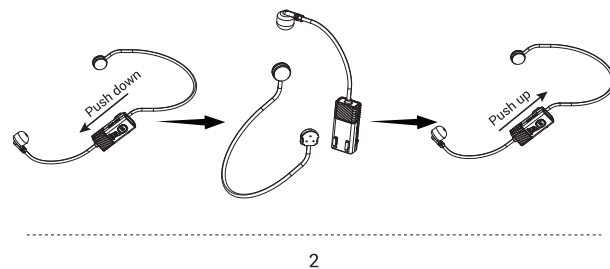

- M** Long press to connect or disconnect
- +** Short press to increase the volume
- Short press to decrease the volume

Microphone and Speaker Auto Pairing

By default, the microphone and the speaker will automatically pair when powered on.

Manually Pairing Handheld and Speaker

1. Turn on the speaker, then briefly press the M button to switch to UHF mode. You will hear the voice prompt 'UHF mode'.
2. Press and hold the M key for approximately 3 seconds until the speaker announces 'UHF is waiting for pairing'.
3. Turn on the handheld microphone, then simultaneously press and hold both '+' and '-' buttons until you hear the device voice prompt 'UHF paired'.
4. Audio output will be available once pairing is complete.
5. Please pair the other microphone in the same way.

Manually Pairing Headset and Speaker

1. Turn on the speaker, then briefly press the M button to switch to UHF mode. You will hear the voice prompt 'UHF mode'.
2. Press and hold the M key for approximately 3 seconds until the speaker announces 'UHF is waiting for pairing'.
3. Power on the headset microphone, then press and hold the M button until you hear the speaker voice prompt 'UHF paired'.
4. Audio output will be available once pairing is complete.

Speaker Charging Status

It takes approximately 3-4 hours to fully charge with DC 5V/3A charger. The battery indicator lights flash while charging, and the indicator lights stop flashing when fully charged.

Headset Microphone Charging Status

It takes approximately 2.5 hours to fully charge with DC 5V/2A charger. The red light remains steady while charging, and it turns off when fully charged.

- Connect the equipment into an outlet on a circuit different from that to which the receiver is connected.
- Consult the dealer or an experienced radio/TV technician for help.

The device has been evaluated to meet general RF exposure requirement. The device can be used in portable exposure condition without restriction.



After-sale service

WinBridge provide one year warranty and lifetime technical support.

 Toll Free Hotline: +1 (833) 996-2881

 info@winbridge.com

<http://www.winbridgestore.com>

Please be confident that seller support is just a mail away from you in case you find any difficulty, kindly do not hesitate to write back to us if you need any clarification or any kind of support.



FCC Warning

Any Changes or modifications not expressly approved by the party responsible for compliance could void the user's authority to operate the equipment.

This device complies with part 15 of the FCC Rules. Operation is subject to the following two conditions:

- (1) This device may not cause harmful interference
- (2) this device must accept any interference received, including interference that may cause undesired operation.

Note

This equipment has been tested and found to comply with the limits for a Class B digital device, pursuant to part 15 of the FCC Rules. These limits are designed to provide reasonable protection against harmful interference in a residential installation. This equipment generates uses and can radiate radio frequency energy and, if not installed and used in accordance with the instructions, may cause harmful interference to radio communications.

However, there is no guarantee that interference will not occur in a particular installation. If this equipment does cause harmful interference to radio or television reception, which can be determined by turning the equipment off and on, the user is encouraged to try to correct the interference by one or more of the following measures:

- Reorient or relocate the receiving antenna.
- Increase the separation between the equipment and receiver.

Specification

Output Power	30W
Frequency Range	60HZ-18KHZ
Speaker Battery	7.4V/3500mAh
Speaker Working Time	5-8 hours
Headset Mic Battery	500mAh
Headset Mic Working Time	5 hours
Handheld Mic Battery	1500mAh
Handheld Mic Working Time	13 hours
Speaker Size	10,5*5,3*12,7 cm / 4.13*2.09*5.00 inch
Speaker Weight	0.538 kg / 1.12 lb

Package Includes

- 1* Voice Amplifier
- 1* Handheld Mic
- 1* Headset Mic
- 1* Double Charging cable
- 1* Charging Cable
- 1* Aux Cable
- 1* Strap
- 1* Manual

Bluetooth Pairing

- 1. For switching to Bluetooth mode:**
"Briefly press the M key on the speaker to activate Bluetooth mode. You'll hear the voice prompt 'Bluetooth mode' indicating successful activation."
- 2. For pairing instructions:**
"Enable Bluetooth on your device and select 'S91' from the available devices list. Upon successful pairing, the speaker will confirm with 'Bluetooth paired' voice prompt."

Note:

1. In Bluetooth mode, short pressing the speaker's M key will switch to other modes, and the Bluetooth connection will be disconnected.
2. To enable simultaneous use of the microphone (via UHF wireless transmission) and music playback (via Bluetooth connection), please follow these steps:
 - a. First, pair the microphone in **UHF mode**
 - b. After successful pairing, briefly press the **M button** to switch to **Bluetooth mode** and connect your playback device

Note: If you connect the Bluetooth device first before pairing the microphone, the Bluetooth connection will be interrupted and both functions cannot be used simultaneously.

Handheld Microphone Charging Status

It takes approximately 3 hours to fully charge with DC 5V/2A charger. The red light remains steady while charging, and it turns off when fully charged.

USB Drive Mode

Insert a UBS drive to automatically play audio files.

Short press **◀◀** to increase volume; long press to skip to next track.

Short press **▶▶** to decrease volume; long press to select previous track.

TF Card Mode

Insert a TF card to automatically play audio files.

Short press **◀◀** to increase volume; long press to skip to next track.

Short press **▶▶** to decrease volume; long press to select previous track.